

Flat

# FLAT 13, ABINGER HOUSE GREAT DOVER STREET, LONDON, SE1 4XU

PCM

## £1,975

FEATURES



# 1 Bedroom Flat located in London

Call us on  
**020 8396 7171**  
  
**hello@newbrix.co.uk**

An attractive one double bedroom second floor flat (lift access) with a large living room, leading out onto a private south facing balcony, a separate fully fitted kitchen, ample storage, bathroom and WC. Permit parking is available.

Abinger House, on Pilgrimage Street, is circa 150 metres from Borough Station and Borough High Street. London Bridge is just beyond, along with Borough Market, the South Bank and numerous other amenities and attractions.

**Council Tax Band**  
  
**A**

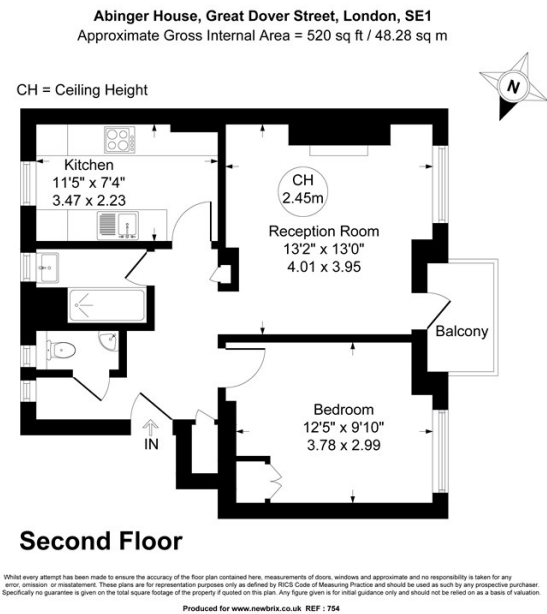

Energy Efficiency Rating		
	Current	Potential
Very energy efficient - lower running costs		
(92 plus) <b>A</b>		
(81-91) <b>B</b>		
(69-80) <b>C</b>		
(55-68) <b>D</b>		
(39-54) <b>E</b>		
(21-38) <b>F</b>		
(1-20) <b>G</b>		
Not energy efficient - higher running costs		
England & Wales		EU Directive 2002/91/EC

Agents Note: Whilst every care has been taken to prepare these particulars, they are for guidance purposes only. All measurements are approximate and are for general guidance purposes only and whilst every care has been taken to ensure their accuracy, they should not be relied upon and potential buyers are advised to recheck the measurements.

